

Licensing Panel (Licensing Act 2003 Functions)

Date: **20 July 2022**

Time: **10.00am**

Venue **Virtual**

Members: **Councillors:** John, Pissaridou, Simson

Contact: **Thomas Bald**
Democratic Services Officer
01273 291354
thomas.bald@brighton-hove.gov.uk

Agendas and minutes are published on the council's website www.brighton-hove.gov.uk.
Agendas are available to view five working days prior to the meeting date.

Electronic agendas can also be accessed through our meetings app available through
ModernGov: [iOS/Windows/Android](#)

This agenda and all accompanying reports are printed on recycled paper

AGENDA

1 TO APPOINT A CHAIR FOR THE MEETING

WELCOME & INTRODUCTIONS

2 PROCEDURAL BUSINESS

(a) **Declaration of Substitutes:** Where Councillors are unable to attend a meeting, a substitute Member from the Licensing Committee may attend, speak and vote in their place for that meeting.

(b) **Declarations of Interest:**

- (a) Disclosable pecuniary interests;
- (b) Any other interests required to be registered under the local code;
- (c) Any other general interest as a result of which a decision on the matter might reasonably be regarded as affecting you or a partner more than a majority of other people or businesses in the ward/s affected by the decision.

In each case, you need to declare

- (i) the item on the agenda the interest relates to;
- (ii) the nature of the interest; and
- (iii) whether it is a disclosable pecuniary interest or some other interest.

If unsure, Members should seek advice from the committee lawyer or administrator preferably before the meeting.

(c) **Exclusion of Press and Public:** To consider whether, in view of the nature of the business to be transacted, or the nature of the proceedings, the press and public should be excluded from the meeting when any of the following items are under consideration.

NOTE: Any item appearing in Part Two of the Agenda states in its heading the category under which the information disclosed in the report is exempt from disclosure and therefore not available to the public.

A list and description of the exempt categories is available for public inspection at Brighton and Hove Town Halls.

3 WINE ME UP PREMISES LICENSING PANEL (LICENSING ACT 2003 FUNCTIONS)

7 - 44

Contact Officer: Corinne Hardcastle
Ward Affected: St Peter's & North Laine

Tel: 0127329

Date of Publication - Tuesday, 12 July 2022

The City Council actively welcomes members of the public and the press to attend its meetings and holds as many of its meetings as possible in public. Provision is also made on the agendas for public questions to committees and details of how questions can be raised can be found on the website and/or on agendas for the meetings.

The closing date for receipt of public questions and deputations for the next meeting is 12 noon on the fourth working day before the meeting.

Meeting papers can be provided, on request, in large print, in Braille, on audio tape or on disc, or translated into any other language as requested. Infra-red hearing aids are available for use during the meeting. If you require any further information or assistance, please contact the receptionist on arrival.

FURTHER INFORMATION

For further details and general enquiries about this meeting contact , (01273 291354, email thomas.bald@brighton-hove.gov.uk) or email democratic.services@brighton-hove.gov.uk

WEBCASTING NOTICE

This meeting may be filmed for live or subsequent broadcast via the Council's website. At the start of the meeting the Chair will confirm if all or part of the meeting is being filmed. You should be aware that the Council is a Data Controller under the Data Protection Act 1998. Data collected during this web cast will be retained in accordance with the Council's published policy.

Therefore, by entering the meeting room and using the seats in the chamber you are deemed to be consenting to being filmed and to the possible use of those images and sound recordings for the purpose of web casting and/or Member training. If members of the public do not wish to have their image captured, they should sit in the public gallery area.

ACCESS NOTICE

The Public Gallery is situated on the first floor of the Town Hall and is limited in size but does have 2 spaces designated for wheelchair users. The lift cannot be used in an emergency. Evac Chairs are available for self-transfer and you are requested to inform Reception prior to going up to the Public Gallery. **For your own safety please do not go beyond the Ground Floor if you are unable to use the stairs.**

Please inform staff on Reception of this affects you so that you can be directed to the Council Chamber where you can watch the meeting or if you need to take part in the proceedings e.g. because you have submitted a public question.

FIRE / EMERGENCY EVACUATION PROCEDURE

If the fire alarm sounds continuously, or if you are instructed to do so, you must leave the building by the nearest available exit. You will be directed to the nearest exit by council staff. It is vital that you follow their instructions:

- You should proceed calmly; do not run and do not use the lifts;
- Do not stop to collect personal belongings;
- Once you are outside, please do not wait immediately next to the building, but move some distance away and await further instructions; and
- Do not re-enter the building until told that it is safe to do so.

Licensing Panel (Licensing Act 2003 Functions)

Brighton & Hove City Council

Subject:	Application for a Variation of a Premises Licence under the Licensing Act 2003		
Premises:	Wine Me Up 7 Lewes Road Brighton BN2 3HP		
Applicant:	Kinan Daoud Baseem Karkour		
Date of Meeting:	20 July 2022		
Report of:	Executive Director of Housing, Neighbourhoods & Communities		
Contact Officer:	Name:	Sarah Cornell	Tel: 01273 295801
	Email:	Sarah.Cornell @brighton-hove.gov.uk	
Ward(s) affected:	St Peter's And North Lane		

FOR GENERAL RELEASE

1. PURPOSE OF REPORT AND POLICY CONTEXT

- 1.1 To determine an application for a Variation of a Premises Licence under the Licensing Act 2003 for Wine Me Up.

2. RECOMMENDATIONS:

- 2.1 That the Panel determine an application for a Variation of a Premises Licence under the Licensing Act 2003 for Wine Me Up.

3. CONTEXT/BACKGROUND INFORMATION & CONSULTATION

- 3.1 The application is for a Variation of a Premises Licence under the Licensing Act 2003. The application proposes an extension of alcohol and opening hours Sun-Thurs from 7am-2am and Fri-Sat 7am-3am.
- 3.2 Section 16 (Operating Schedule) of the application is detailed at Appendix A

3.3 Summary table of existing and proposed activities

	Existing	Proposed
Supply of Alcohol	Monday to Saturday 10:00 – 01:00 Sunday 10:00 – 00:00 Off the Premises	Sunday to Thursday 07:00 – 02:00 Friday to Saturday 7:00 – 03:00 Off the Premises
Hours premises are open to public	Every Day 10:00 – 01:00	Sunday to Thursday 07:00 – 02:00 Friday to Saturday 7:00 – 03:00

3.4 Existing licence attached at Appendix B

3.5 Special Stress Area: The premises falls within the Special Stress Area. This area is deemed an area of special concern in terms of the levels of crime, disorder, and public nuisance experienced within them. (See paragraphs 3.2 – 3.2.5)

Representations received

3.6 Details of the representations made are notified to applicants on receipt by the Licensing Authority using a pro-forma. A summary appears below:

3.7 Two representations were received. They were received from Sussex Police and The Licensing Authority

3.8 Representations received had concerns relating to Prevention of Crime and Disorder and Prevention of Public Nuisance.

3.9 Full details of the representations are attached at Appendix C. A map detailing the location of the premises is attached at Appendix D.

4. COMMENTARY ON THE LICENSING POLICY

4.1 The following extracts from Brighton & Hove City Council Statement of Licensing Policy are considered relevant to this application and **are numbered as they appear in the policy**:

1 Introduction

1.1 This Statement of Licensing Policy has been prepared in accordance with the provisions of the Licensing Act 2003 (the Act) and having regard to Guidance issued by the Home Office under Section 182 of the act. This policy takes effect from the 4th February 2021. The licensing authority is Brighton & Hove City Council. The purpose of this statement is to promote the licensing objectives and set out a

general approach to making licensing decisions. The discretion of the licensing authority in relation to applications under the act is only engaged if 'relevant representations' are made by other persons or responsible authorities. This policy will inform the approach to be taken when deciding applications and imposing conditions when relevant representations are received. It is also intended as a guide for applicants as to what to include in their operating schedules, always recognising that if no representations are received, the application must be granted. The licensing authority must carry out its functions with a view to promoting the licensing objectives and this policy is framed around those objectives. Each application will be given individual consideration on its merit. The scope of this policy covers the following:

- Retail sales of alcohol.
- The supply of alcohol by or on behalf of a club, or to the order of, a member of the club.
- The provision of regulated entertainment.
- The provision of late night refreshment.

1.2 The licensing objectives are:

- (a) the prevention of crime and disorder.
- (b) public safety.
- (c) the prevention of public nuisance; and
- (d) the protection of children from harm.

1.3 Scope

1.3.1 Licensing is about regulating licensable activities on licensed premises, by qualifying clubs and at temporary events. Any conditions attached to various authorisations will be focused on matters which are within the control of individual licensees and others with relevant authorisations, i.e. the premises and its vicinity. Each application will be given individual consideration on its merit. Nothing in this policy shall undermine the right of any individual to apply under the terms of the act for a variety of permissions and to have any such application considered on its individual merits. Similarly, nothing in this policy shall override the right of any person to make representations on an application or seek a review of a licence or certificate where provision has been made for them to do so in the act.

3 Special Policies and Initiatives

3.2 Special Stress Area

3.2.1 The map below details the area of the city centre which borders the Cumulative Impact zone at 3.1.3 and which is deemed an area of special concern in terms of the levels of crime and disorder and public nuisance experienced within it. The area recommended for further monitoring and detailed guidance within the Special Policy comprise the following as pictured below delineated in purple:

Special Stress Area and Cumulative Impact Zone, January 2021

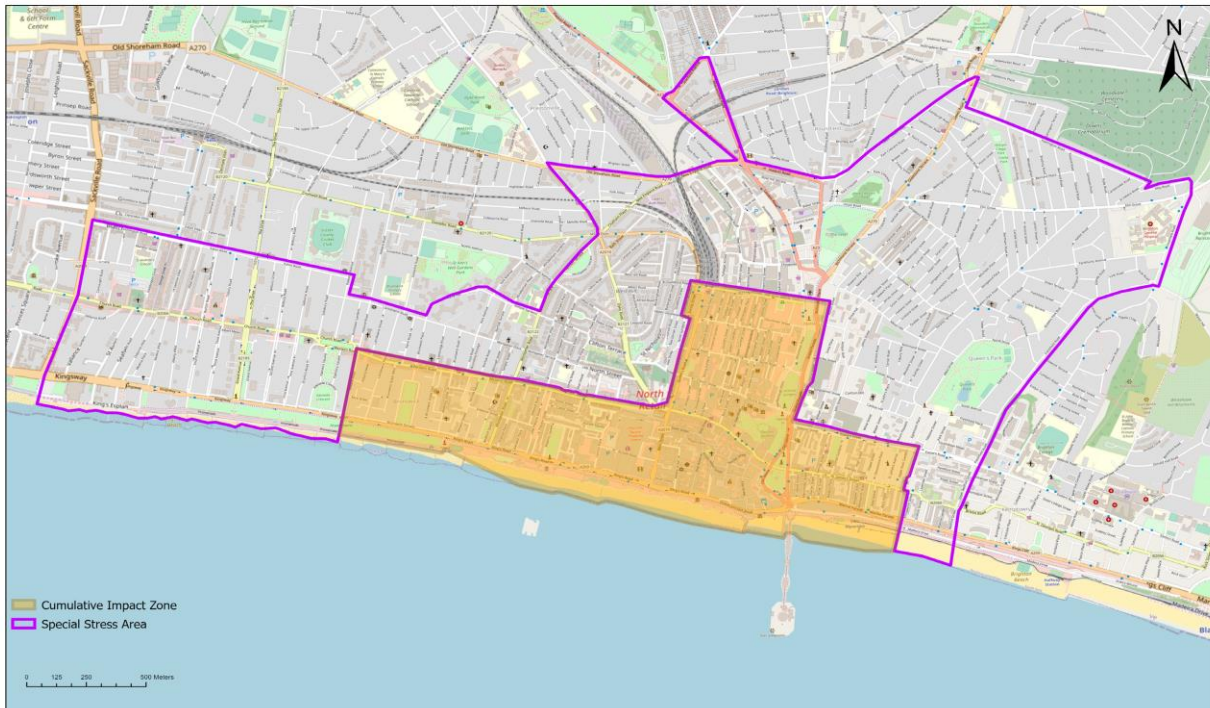

Brighton & Hove Public Health Intelligence, 2021
© OpenStreetMap (and) contributors, CC-BY-SA © Crown Copyright. All rights reserved. Licence: 100020999. Brighton & Hove City Council. 2019. Cities Revealed © 2018

The Special Stress Area - an area bounded by and including: The west side of Hove Street/Sackville Road, northwards to the intersection with the north side of Blatchington Road, along north side of Blatchington Road and Eaton Road, southwards at the junction onto the east side of Palmeira Avenue and then eastwards at the junction onto the north side of Landsdowne Road; eastwards to the junction with Furze Hill, along the north side Furze Hill to its end and then due east along the north side of Victoria Road to its junction with Montpelier Road (west side), north to where Montpelier Road joins Vernon Terrace then north to Seven Dials; north west along the west side of Dyke Road until the junction with the Old Shoreham Road, then East along the north side of Old Shoreham Road, continuing on the north end of New England Road, north west at Preston Circus at the junction of New England Road and Preston Road along the west side of Preston Road until the junction with Stanford Avenue then and north east along the north side of Stanford Avenue until the junction with Beaconsfield Road, south along the east side of Beaconsfield Road until the junction at Preston Circus and Viaduct Road, eastwards along the north side of Viaduct Road, then at the junction with Ditchling Road, North East along the north side of Upper Lewes Road until the junction with Lewes Road; south along the Lewes Road to junction with Hartington Road, along the north side of Hartington Road until the junction with St. Helen's Road, south into the north side of May Road, eastwards until its junction with Freshfield Road (east side), then south into Upper Bedford Street, into Bedford Street to the mean water mark south of Bedford Street, then due west until the mean water mark south of Lower Rock Gardens; North on Upper Rock gardens, to the north side of Eastern Road, west along Eastern Road and Edward Street until Grand Parade, north along the Eastern side of Grand Parade to the junction of York Place and Trafalgar Street, West along the Northern boundary of Trafalgar Street, up to and including Surrey Street and then South along the Western boundary of Queens Road to the junction with Air Street, West along the north side of Air Street, South-west to the junction of Western Road Brighton, then West along the North side of Western Road Brighton, South along the West side of Holland Road to the mean water mark south of Kingsway and Kingsway Esplanade as far as the west side of Hove Street/ Sackville Road.

3.2.2 This Special Stress Area (SSA) is of concern to the licensing authority because of the relatively high levels of crime and disorder and nuisance experienced within it. The area will be kept under review.

3.2.3 New and varied applications for premises and club premises certificates within the SSA will not be subject to the presumption of refusal, but operators will be expected to pay special attention when drawing up their operating schedules and to make positive proposals to ensure that their operation will not add to the problems faced in these areas. Appendix A of the SoLP sets out a list of potential measures the licensing authority considers may be appropriate. These may be more or less appropriate depending upon the style of operation applied for.

3.2.4 On receipt of any application in the SSA, where a relevant representation has been made, the licensing authority will scrutinise the application carefully and will look at the measures proposed in the operating schedules and compare them to the measures set out in Appendix A, Licensing Best Practice Measures. Where discretion has been engaged, those applications which fall short may be refused or conditions applied to comply with policy measures.

3.2.5 The Licensing Authority will keep the Cumulative Impact Zone and Special Stress Area under review. Should the authority find that problems of crime and disorder or nuisance are not improving, or are worsening, the Special Policy will be reviewed.

3.3 The Matrix Approach

The Licensing Authority will support:

3.3.1 Diversity of premises: ensures that there is a mix of the different types of licensed premises and attracts a more diverse range of customers from different age groups, different communities and with different attitudes to alcohol consumption. It gives potential for positively changing the ambience of the city or an area of it. This will have a positive effect in reducing people's fear of crime and in increasing the number of evening visitors to the city centre. The Community Safety Strategy recognises that too many single uses in a confined area and patrons turning out onto the streets at the same time may create opportunities for violent crime and public disorder and therefore supports mixed use venues encouraging a wider age balance.

3.3.2 A "matrix" approach to licensing decisions has been adopted and is set out below. It provides a framework of what the licensing authority would like to see within its area and gives an indication of the likelihood of success or otherwise to investor and businesses making applications.

Matrix approach for licensing decisions in a Statement of Licensing Policy (times relates to licensable activities)

	Cumulative Impact Area	Special Stress Area	Other Areas
Restaurant	Yes (midnight)	Yes (midnight)	Yes (midnight)
Café	Yes (10 pm)	Yes (10 pm)	Yes (10 pm)
Late Night Takeaways	No	Yes (midnight)	Yes (midnight)
Night Club	No	No	No
Pub	No	Yes (11pm)	Yes (midnight)
Non-alcohol lead (e.g. Theatre)	Yes (favourable)	Yes (favourable)	Yes (favourable)
Off-licence	No	No	Yes (Up to 11pm but if in densely residential area may be earlier – see note 7 below)
Members Club (club premises certificate)	Yes (<100 capacity) (11pm)	Yes (<100 capacity) (11pm)	Yes

Notes on matrix

Subject to the following notes, the policy, as represented in the matrix, will be strictly adhered to:

- 1) Each application will be considered on individual merit
- 2) Applications within the CIZ are subject to the special policy on cumulative impact at para 3.1, and those within the special stress area to the special stress policy considerations at para 3.2.
- 3) Departure from the matrix policy is expected only in exceptional circumstances
- 4) Exceptional circumstances will not include quality of management or size of venue except where explicitly stated in policy matrix.
- 5) Exceptional circumstances may include: consultation with and meeting requirements of responsible authorities, an appropriate corporate social responsibility policy, community contribution to offset impact (such as financial contribution to infrastructure), community support, alcohol sale ancillary to business activity (demonstrable to responsible authorities and licensing authority, for instance by licence condition allowing authorised officers access to sales accounts).

6) The following licensing activities are encouraged and valued by the licensing authority: outdoor regulated entertainment, community based street parties, members clubs, traditional pubs outside the city centre and non-alcohol led licensable activities, particularly within city centre.

7) Other Areas; consideration will be given to the nature of the area and location in relation to any application. In a residential area for example the concerns of local residents will be relevant when considering applications for off-licences, pubs or cafes, especially if there is evidence of anti-social behaviour, street drinking or underage drinking. Earlier closing times may be appropriate. Regard will be had to the Public Health Framework for assessing alcohol licensing on our website www.brighton-hove.gov.uk/licensingact.

8) In an area where there are already several existing off-licences or where the premises is situated within a parade with another off licence and where representations are received about negative cumulative impact on the licensing objectives of a further premises, the application may be refused on these grounds or restrictions placed on the terminal hour to reflect opening hours of other shops.

9) Outdoor events will be supported where arranged through the council's event planning process. Generally, regulated entertainment in the open air including tents and marquees should have a maximum closure hour of 2300. Earlier hours may be imposed in sensitive open spaces or near residential areas. The licensing authority will have regard to Noise Council guidance.

10) Non-alcohol led category does not include "alcohol in shared workplaces". It is recommended that sale of alcohol in shared workspaces should have a terminal hour of no later than 10pm. For further advice and guidance on "alcohol in shared workplaces" please see paragraph 3.3.4-3.3.6.

3.5 Off licences

In recent years there has been a noticeable shift towards more people buying alcohol from shops and drinking at home prior to going into premises such as pubs and clubs. The council is concerned that alcohol loading from off-licence sales is a significant problem in the city and adversely affects the licensing objectives as it gives rise to problems of drunkenness, disorderly behaviour and a higher risk of alcohol sales to children. Representations from the police, local residents and the director of public health at licensing panel hearings have testified to these problems and Information published in the Public Health Framework for assessing alcohol licensing presents a ward by ward analysis of crime and disorder and health data which is relevant in this respect.

3.5.1 The special policy on cumulative impact and the special stress areas apply to off licences as explained in the matrix approach at 3.3. But in general, where applications are made for new premises or variations to existing licences, and where the police or others make representations against the grant of a further licence for off sales, the council will give specific consideration to restricting the number, type, and the hours of premises selling alcohol exclusively for consumption off the premises. Decisions will be grounded in the Public Health Framework for assessing alcohol licensing. The council will want to be assured that the operating schedule of premises, and their overall management, training and levels of staffing,

are appropriate to ensure that the licensing objectives are promoted in what may be challenging circumstances. Retail outlets and stores where the provision of fresh produce is the principal product sold maybe considered more favourably.

3.5.2 The Licensing Authority encourage off licences to join the Council led “Sensible on Strength” scheme to reduce the availability of cheap super strength beers and ciders. Off licences voluntarily sign up not to sell cheap super-strength beers and ciders over 6% ABV and operate good practice measures (see 3.5.3) for which they receive an accreditation as a responsible retailer.

3.5.3 Areas of best practice that may be included in an Operating Schedule include

- the installation of a digital CCTV system by liaison with, and to a standard approved by Sussex Police
- Challenge 25 policy
- Refusals system
- Documented staff training including underage sales, drunkenness and proxy sales
- Voluntary restriction of high strength alcohol - operating schedules may be used to limit high ABV beers and ciders
- BCRP membership (or other accredited scheme)
- No sale of single cans
- Displays should not be located at the entrance/exit points or near checks out

3.5.4 The Licensing Authority and Sussex Police have specific concerns around the delivery of alcohol off the premises due to issues around the end location of delivery, age verification checks (Challenge 25), the increased possibility of the alcohol coming into the CIZ and SSA from other areas, as well as the personal safety of drivers when having to refuse a delivery at the end destination.

3.5.5 Alcohol delivery poses a unique set of challenges as it often transfers the final age verification to a person who has no responsibility in relation to the Premises Licence which authorised the sale of alcohol. A premises licence holder needs to be satisfied that their drivers or the delivery drivers of the third party company they chose to use, have received regular and comprehensive training in age verification and identifying persons who have consumed too much alcohol.

3.5.6 Evidence has shown that customers have previously used landmarks/businesses not related to them as addresses for delivery so that alcohol could be consumed in open spaces/parks. The risk being that this may lead to increased crime and disorder including anti-social behaviour and criminal damage, as well as the possibility that underage persons can gain access to alcohol. Concerns have also been raised about the delivery of alcohol to known street drinking hotspots. Therefore, a condition requiring all deliveries to be to a verifiable residential or business address and a face to face ID verification is vital in mitigating some of this risk.

3.5.7 While the Licensing Authority and Sussex Police recognise this is a growing area of business, new or variation applications to include the delivery of alcohol off the premises will be subject to increased scrutiny. Suggested conditions for the provision of an alcohol delivery service can be found at Appendix A. These are not exhaustive and each application will be considered on its own merits.

3.6 Street drinking

3.6.1 The Licensing Authority will have regard to areas highlighted by Sussex Police that are at risk from alcohol related anti-social behaviour. The nature of these areas can be fluid/seasonal and so updated maps and data will be produced regularly to ensure the information is current. These hot spot areas are considered high risk for street drinkers and the Licensing Authority will have regard to prevention of crime and disorder by virtue of street drinking and anti-social behaviour when considering applications in this area.

4 Prevention of Crime and Disorder

The following details and measures are intended to address the need for the prevention of crime and disorder which may be associated with licensed premises and certificated club premises. Conditions attached to licences and certificates will, as far as possible, reflect local crime reduction strategies.

- 4.1.1 The licensing authority acknowledges that training and good management play a key part in preventing alcohol and drug related crime. The authority expects that all licensees of on-licensed premises attend training programmes which will raise their awareness of the issues relating to drugs and violence in licensed premises, and that suitable training be extended to all bar staff and door supervisors so that drug dealers and users will be deterred from using licensed premises for illegal purposes and that incidents of violence in licensed premises will be reduced. Licensees are also encouraged to attend training programmes to help identify children at risk and issues of basic child protection. It is the duty of the designated premises supervisor (DPS) to train staff on induction concerning conditions on their premises licence.
- 4.1.2 It is expected that the DPS will spend a significant amount of time on the premises. When not on the premises it will be essential that the DPS is contactable, particularly should problems arise with the premises and that staff are authorised by the DPS.
- 4.1.3 The location of violent attacks, anti-social behaviour and hate crime or related incidents may be used to justify closing times.
- 4.1.4 Measures put in place should support the intentions of Operation Marble (police operational order), which aims to prevent incidents of crime and disorder within the night time economy, at weekends. Operation Marble operates with a view to minimising the risk to the public of being a victim of public place violent crime; to reduce incidents of violent crime and public disorder within the city centre; to deal positively with offences and offenders; to secure and preserve evidence which will assist in the prosecution of offenders and to support the night time economy and the responsibly run businesses within it.

4.2 Sussex Police

4.2.1 Sussex Police have a specific Operation relating to the night time economy called Operation Marble (detailed in 3.4.1) and work closely with partners to ensure a safe and vibrant city centre. There continues to be an increasing demand for resources further into the early hours of the morning with the highest concentration of crimes occurring between 21:00 and 06:00 on a Friday into a Saturday and between 20:00 and 06:00 on a Saturday night into a Sunday. The data set used shows that up to 80% of arrests made in the timeframe 20:00 – 06:00 on these days were affected by alcohol. For full details of these statistics see the Cumulative Impact Assessment at Appendix E.

4.2.2 The dealing and use of drugs remains an issue across the city and Sussex Police welcome proactive policies from licensed premises. A drug safe and seizure recording initiative is in place of which further details can be obtained by contacting Brighton & Hove Police Licensing (brighton.licensing@sussex.pnn.police.uk). This initiative encourages licensed premises with Door Supervisors to search and seize drugs from persons attempting to enter their premises and ensures that once drugs are removed from persons, they can be safely collected and destroyed by Sussex Police.

4.2.3 Dispersal from the city centre during the late evening and early morning remains a policing challenge. Over recent years, there has been a proliferation of off-licences and late night refreshment venues along the city's arterial routes. This has led to incident 'hot spots' where patrons from the night time economy continue to interact, albeit away from any safety measures afforded by on-licences. As such, Sussex Police support the Council's Special Policy in offering guidance to both applicants and the Licensing Committee in relation to off-licences and late night refreshment licences.

4.2.4 Sussex Police have continuing concerns that, despite staff training in age-restricted sales, under age individuals are still being served alcohol both on and off the premises in some of the city's licensed premises. As such, regular intelligence-led 'test-purchase' operations are conducted to highlight premises where sales are taking place and ensure appropriate enforcement action is taken to prevent further sales. The introduction of identification scanning machines at premises throughout the city has proved successful in mitigating some risk, but operators must maintain vigilance regarding the fraudulent use of genuine IDs. Sussex Police continue to work alongside the Business Crime Reduction Partnership to tackle the problem of those who use false or another's identification to enter licensed premises and purchase alcohol.

4.2.5 Sussex Police work closely with venues and other organisations within the city to protect vulnerable people from becoming victims of crime. As well as work to prevent under age sales, vulnerability training is offered to identify persons who may have been made vulnerable through alcohol or drugs. Sussex Police also support initiatives such as (but not limited to) safe spaces, mobile teams of volunteers actively checking people's well-being and the Beach Patrol.

4.2.6 Public Space Protection Orders have proved an effective tool for Sussex Police in targeting enforcement action in problem areas of the city. It 'allows Police Officers and Police Community Support Officers to remove alcohol from any person in a public place if that person is involved in anti-social behaviour (ASB) or the officer believes that by having alcohol in their possession there is an increased risk of ASB. It is an offence to refuse to hand over alcohol when required to do so.' They have been particularly effective in the day time economy where members of the street community are causing ASB issues for members of the public and local businesses, especially during the summer months where there is a large influx of visitors to Brighton & Hove.

4.2.7 Policing the night time economy continues to provide a challenge and in the climate of limited resources and newly emerging problems, Sussex Police support maintaining the council's Special Policy which defines cumulative impact and special stress and will continue to take enforcement action where appropriate if the actions of a Premises Licence Holder, Designated Premises Supervisor, Door Supervisors or Staff have fallen below the high standard expected across the city. Sussex Police also recognise and support businesses which are aware of their social responsibilities and as such, actively contribute towards keeping Brighton & Hove a safe and enjoyable city.

4.3 Care, control and supervision of premises

4.3.1 The Licensing authority supports the Business Crime Reduction Partnership and other approved schemes. Where appropriate, premises licence holders should be members of the BCRP for the deterrence to violent crime that such membership provides. The BCRP NightSafe radio scheme is normally expected as an operational requirement for city centre bars, clubs and pubs and is an example of good practice in achieving the aim of reducing crime and disorder and improving public safety. Well managed pub-watch schemes provide information exchange between the premises licence holders and responsible authorities that reduce and deter violent crime and disorder. The council will support a responsible licensing scheme.

4.3.2 The effective management and supervision of a venue is a key factor in reducing crime and disorder, both within it and outside. The police will consider the applicants, objecting to the application where appropriate. The police may suggest crime prevention measures in relation to, for example, the internal layout of the premises, closed-circuit television, help points, lighting and security staff. The police may ask for conditions which support such measures to be imposed when licensing applications are granted, eg type of licence, capacity, operating hours restrictions.

4.3.3 Following the grant of a licence, the management and supervision of the premises, in so far as it might impact on crime and disorder, will continue to be monitored. Particular attention will be paid to any licensed premises where there is evidence of criminal activity or any association with racist or homophobic crime. The licensing authority will keep itself well briefed on the nature, location and type of premises where alcohol related violence and disorder are occurring so it can take full account of the facts and avoid exacerbating problems as required by the Community Safety Strategy. Where licensed premises are found to cause nuisance or be

associated with disorder or unreasonable disturbance, the review process may be invoked, and powers of revocation or the imposition of conditions may be considered. Conditions may include use of closed-circuit television, licensed door supervisors and earlier closing times. Such action to restrict the operation may be taken for trial periods to allow businesses an opportunity to remedy existing disorder, nuisance or disturbance.

4.3.4 This policy recognises the use of registered Door Supervisors All Door Supervisors will be licensed by the Security Industry Authority. Mobile security units and similar systems are in use by some premises operators as a means of providing security cover at very short notice at premises which may not normally require a permanent security presence. This policy endorses the use of units following such guidance and standards in appropriate circumstances.

4.3.5 The development of codes of practice and general operating standards for security companies is encouraged for local businesses; premises operators are urged to ensure that security services, when engaged, are provided by suitably qualified businesses operating to recognised standards and who should be working towards SIA accreditation.

4.3.6 Enforcement will be achieved by the enforcement policy appended (Appendix B).

6 Prevention of Public Nuisance

The following details and measures are intended to address the need for the prevention of public nuisance which may be associated with licensed premises and certificated club premises:

6.1.1 In determining applications for new and varied licences, regard will be had to the location of premises, the type and construction of the building and the likelihood of nuisance and disturbance to the amenity of nearby residents by reason of noise from within the premises, as a result of people entering or leaving the premises or from individuals or groups of customers gathered outside (eg in order to smoke).

6.1.5 In determining applications for new licences or extensions in hours or terminal hours of licensed premises, regard will be had to late night public transport availability and location of taxi ranks to aid dispersal of customers.

6.2.2 Licensed premises should normally display prominent, legible signs at exits reminding customers to leave in a quiet, peaceful, orderly manner.

8 Integration of Strategies

8.1.1 The licensing authority shall secure the proper integration of this policy with local crime prevention, planning policy, transport, tourism and cultural strategies by:-

- Liaising and consulting with the Sussex Police, Community Safety Forum, Sustainability Commission representatives and following the guidance in community safety and crime and disorder strategy
- Liaising and consulting with Public and Alcohol Programme Board
- Liaising and consulting with the East Sussex Fire & Rescue Service

- Liaising and consulting with the Local Strategic Partnership, Safety Advisory Group (Emergency Planning) and Equalities and Social Justice Consultation Forum
- Liaising and consulting with the Planning authority
- Liaising and consulting with the Highways authority
- Liaising and consulting with local business and business associations. Having regard to any future documents issued relating to the Private Security Industry Act 2001, for example liaison or information sharing protocols
- Liaising and consulting with the Trading Standards Team, for example with regard to test purchasing codes of practice

8.1.2 In line with statutory requirements and the council's Inclusion Policy, the Licensing Authority shall have due regard to the need to eliminate unlawful discrimination, and to promote equality of opportunity and positive relations between persons of diverse backgrounds, for example communities of interest such as: lesbian, gay, bisexual and transgender people; disabled people; racial and ethnic groups; religious and faith groups.

8.1.3 This policy supports the aims of the tourism strategy, recognising the benefits for the tourism economy of creating a safer and more attractive city centre and improving competitiveness with other European cities. The Licensing Committee should receive any reports relevant to the needs of the local tourist economy and the cultural strategy for the area to ensure that it considers these matters.

8.1.4 The Licensing Committee should receive relevant information relating to the employment situation of the area and the need for new investment and employment where appropriate.

8.1.5 Specific conditions may be attached to premises licences to reflect local crime prevention strategies. Such conditions may include the use of closed circuit television cameras, use of the NightSafe radio system or accredited scheme, the provision and use of shatterproof drinking receptacles, drugs and weapons search policy, the use of registered door supervisors, specialised lighting requirements, hours of opening. Certificates issued to club premises shall reflect local crime prevention strategies and may include any or all of the requirements listed above.

8.1.6 The licensing authority will have regard to the need to disperse people quickly and safely from the city centre to avoid concentrations which may produce disorder and disturbance.

8.3 Enforcement

8.3.1 The Enforcement of licensing law and inspection of licensed premises is detailed in the Protocol between Sussex Police, the East Sussex Fire & Rescue Service and Brighton & Hove City Council. This protocol reflects the need for more efficient deployment of Police and Local Authority staff commonly engaged in licensing enforcement and can be found at Appendix D (Lead Agency Status) of the Statement of Licensing Policy. In addition, the Licensing Authority will have regard to its published Licensing Enforcement Policy in making enforcement decisions in accordance with Brighton & Hove City Council's Statement of Licensing Policy (Appendix B). In order to better target enforcement resources, inspections will be

undertaken outside of normal office hours and the sharing of information between all enforcement agencies will be encouraged through joint meetings or similar arrangements.

8.3.2 Attention is drawn to the targeting of agreed problem and high risk premises requiring greater attention as identified in the protocol. A number of other council and government policies, strategies and guidance documents must be taken into account to complement the policy, including:

- Community Safety & Crime Reduction Strategy
- Drugs and alcohol strategies – local alcohol harm reduction strategy
- Objectives of the Security Industry Authority
- The Anti-Social Behaviour Act 2003/ASBPC Act 2014
- The Health Act 2006
- The Violent Crime Reduction Act 2006
- Policing and Crime Act 2009

APPENDIX A – Licensing Best Practice Measures

Best Practice Measures to be included for consideration, in particular in SSA: Matters that would normally be expected in operating schedules:

- the adoption of a policy (e.g. Challenge 25) with acceptable proof of ID as per existing Statement of Licensing Policy
- all off sales to be made in sealed containers for consumption away from the premises
- a smoking policy which includes an assessment of noise and litter created by premises users
- the use of plastic or polycarbonate drinking vessels and containers, especially in outside areas or after specified hours
- a policy in relation to searching customers and for drugs, weapons, seized or lost and found property
- use of a refusals book for registering attempts to buy alcohol by under-age persons or refusals to those intoxicated
- the installation of a digital CCTV system by liaison with, and to a standard approved by, Sussex Police
- policies for dispersal of customers which may include signage regarding taxi services' telephone numbers and advice to respect neighbours and minimize noise

Items to which positive consideration would be given:

- membership of Business Crime Reduction Partnership, Pubwatch, Neighbourhood Watch or similar schemes
- use of 'Night Safe' radio system or similar accredited scheme
- regular training and reminders for staff in respect of licensing legislation, policies and procedures; records of which should be properly recorded and available for inspection
- records of regular checks of all parts of the premises in relation to drug use
- systems in place to ensure details of barred clients are exchanged with other operators
- giving an agreed minimum notice of special events (screening of major

sports events, birthday parties, adult entertainment, etc.) to relevant authorities and use of appropriate additional measures at such events

Recommend best practice for both on and off premises

- Staff must be aware of the risk of the problem of proxy sales and offer assistance to responsible authorities to deter offences
- Signage on premises should set out legal duties
- Voluntary restriction of high strength alcohol – operating schedules may be used to limit high ABV beers and ciders
- Staff training – in addition to personal licence holders training, staff must be adequately trained for duties
- Challenge 25 would be the norm, particularly in the off licence trade
- Signage – proxy sale – deterrence

5. FINANCIAL & OTHER IMPLICATIONS:

Financial Implications:

- 5.1 The Licensing Act 2003 provides for fees to be payable to the licensing authority in respect of the discharge of their functions. The fee levels are set centrally at a level to allow licensing authorities to fully recover the costs of administration, inspection and enforcement of the regime.

Finance Officer Consulted Michael Bentley

Date: 01/07/22

Legal Implications:

- 5.2 The licensing authority must act to promote the four licensing objectives which are:

- The prevention of crime and disorder
- Public safety
- The prevention of public nuisance
- The protection of children from harm

The licensing authority must have regard to its statement of licensing policy and the guidance issued by the Secretary of State in carrying out its functions.

Lawyer Consulted: Rebecca Sidell

Date: 04.07.2022

Equalities Implications:

- 5.3 Diversity is valued and strong, safe communities are vital to future prosperity. Licensing policy aims to protect children from harm including sale and supply of alcohol to children.

Sustainability Implications:

- 5.4 Licensing policy aims to prevent public nuisance and develop culture of live music, dancing and theatre.

SUPPORTING DOCUMENTATION

Appendices:

1. Appendix A – Section 16 (Operating Schedule)
2. Appendix B – Part A of Premises Licence
4. Appendix C – Representations
5. Appendix D – Map of area

Documents in Members' Rooms

Brighton & Hove City Council, Licensing Act 2003: Statement of Licensing Policy 2021.

Home Office, Revised Guidance issued under section 182 of the Licensing Act 2003, April 2018.

Public Health Framework for Assessing Alcohol Licensing – January 2022.

Background Documents

Brighton & Hove City Council, Licensing Act 2003: Statement of Licensing Policy 2021.

Appendix A

Section 16 of 18

LICENSING OBJECTIVES

Describe the steps you intend to take to promote the four licensing objectives:

a) General – all four licensing objectives (b,c,d,e)

List here steps you will take to promote all four licensing objectives together.

b) The prevention of crime and disorder

two staff working in shop in all the busy time

we have a security radio always on

c) Public safety

1 CCTV working all the time

2 no display of alcohol promotion it can seen by the people from outside the premises

3 the locate of the alcohol not putted near the entrance

4 no direct public access to the spirit and tobacco

5 we keep the refusing book on the counter to who look an under age or drunk

d) The prevention of public nuisance

we don't have any active in the premises

we always do capacity no more than 6 people in the premises to avoid any annoying to the neighbors

e) The protection of children from harm

No alcohol miniature size reachable on the counter

all alcohol spirit is behind the counter

alcohol fridge is in the last point inside the shop

all the staff holding alcohol personal licence which know how to deal with the children quietly

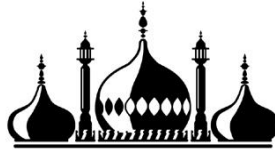

Brighton & Hove City Council

Schedule 12 Part A

Regulation 33, 34

Premises Licence Brighton and Hove City Council

Premises Licence Number

1445/3/2022/00372/LAPRET

Part 1 – Premises Details

Postal address of premises, or if none, ordnance survey map reference or description, including Post Town, Post Code

Wine Me Up
7 Lewes Road
Brighton
BN2 3HP

Telephone number

Where the licence is time limited the dates -

Licensable activities authorised by the licence

Sale by Retail of Alcohol

Times the licence authorises the carrying out of licensable activities

Sale by Retail of Alcohol

Monday - Saturday 10:00 – 01:00

Sunday 10:00 – 00:00

The opening hours of the premises

Every Day 10:00 – 01:00



Brighton & Hove City Council

Where the licence authorises supplies of alcohol whether these are on and / or off supplies
Alcohol is supplied for consumption off the Premises.

Part 2

Name, (registered) address, telephone number and email (where relevant) of holder of premises licence

Baseem Karkour
Redacted Text

Kinan Daoud
Redacted Text

Registered number of holder, for example company number, charity number (where applicable) – N/A

Name, address and telephone number of designated premises supervisor where the premises licence authorises for the supply of alcohol

Redacted Text
Redacted Text

Personal licence number and issuing authority of personal licence held by designated premises supervisor where the premises licence authorises for the supply of alcohol

Redacted Text



Brighton & Hove City Council

Annex 1 – Mandatory conditions

S 19; mandatory conditions where licence authorises supply of alcohol

1. No supply of alcohol may be made under the premises licence
 - a) at a time when there is no designated premises supervisor in respect of the premises, or
 - b) at a time when the designated premises supervisor does not hold a personal licence or his personal licence is suspended
2. Every supply of alcohol under the premises licence must be made or authorised by a person who holds a personal licence
5. (1) The premises licence holder or club premises certificate holder must ensure that an age verification policy is adopted in respect of the premises in relation to the sale or supply of alcohol.
(2) The designated premises supervisor in relation to the premises licence must ensure that the supply of alcohol at the premises is carried on in accordance with the age verification policy.
(3) The policy must require individuals who appear to the responsible person to be under 18 years of age (or such older age as may be specified in the policy) to produce on request, before being served alcohol, identification bearing their photograph, date of birth and either—
 - (a) a holographic mark, or
 - (b) an ultraviolet feature.

Minimum Drinks Pricing

1. A relevant person shall ensure that no alcohol is sold or supplied for consumption on or off the premises for a price which is less than the permitted price.
2. For the purposes of the condition set out in paragraph 1 —
 - (a) “duty” is to be construed in accordance with the Alcoholic Liquor Duties Act 1979;
 - (b) “permitted price” is the price found by applying the formula—
$$P=D+(D \times V)$$
where—
 - (i) P is the permitted price,
 - (ii) D is the amount of duty chargeable in relation to the alcohol as if the duty were charged on the date of the sale or supply of the alcohol, and
 - (iii) V is the rate of value added tax chargeable in relation to the alcohol as if the value added tax were charged on the date of the sale or supply of the alcohol;

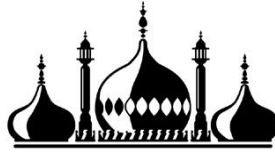

Brighton & Hove City Council

(c) “relevant person” means, in relation to premises in respect of which there is in force a premises licence—

- (i) the holder of the premises licence,
- (ii) the designated premises supervisor (if any) in respect of such a licence, or
- (iii) the personal licence holder who makes or authorises a supply of alcohol under such a licence;

(d) “relevant person” means, in relation to premises in respect of which there is in force a club premises certificate, any member or officer of the club present on the premises in a capacity which enables the member or officer to prevent the supply in question; and

(e) “value added tax” means value added tax charged in accordance with the Value Added Tax Act 1994.

3. Where the permitted price given by Paragraph (b) of paragraph 2 would (apart from this paragraph) not be a whole number of pennies, the price given by that sub-paragraph shall be taken to be the price actually given by that sub-paragraph rounded up to the nearest penny.
4. (1) Sub-paragraph (2) applies where the permitted price given by Paragraph (b) of paragraph 2 on a day (“the first day”) would be different from the permitted price on the next day (“the second day”) as a result of a change to the rate of duty or value added tax.
(2) The permitted price which would apply on the first day applies to sales or supplies of alcohol which take place before the expiry of the period of 14 days beginning on the second day.

Annex 2 – Conditions consistent with the Operating Schedule

The Prevention of Crime and Disorder:

1. Digital CCTV and appropriate recording equipment to be installed, operated and maintained throughout the premises externally and internally to cover all public areas with sufficient numbers of cameras as agreed with Sussex Police. CCTV footage will be stored for a minimum of 28 days, and the management will give full and immediate cooperation and technical assistance to the Police in the event that CCTV footage is required for the prevention and detection of suspected or alleged crime. The CCTV images will record and display dates and times, and these times will be checked regularly to ensure their accuracy. The management of the premises will ensure that key staff are fully trained in the operation of the CCTV, and will be able to download certain footage onto a disk for the police without difficulty or delay.

Public Safety:

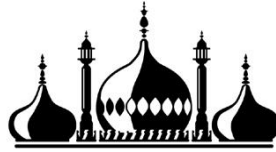

Brighton & Hove City Council

2. The applicant will have two members of staff on the premises from 21:00hrs to 01:00hrs Friday and Saturday whilst alcohol is on sale.

The Prevention of Public Nuisance:

3. Suitable signage will be displayed at the exit requesting patrons to respect neighbours and leave quietly.
4. Patrons congregating or talking loudly outside the premises will be asked to move on quietly and quickly.
5. Staff will be trained to keep noise to a minimum when disposing of rubbish and closing up.

The Protection of Children from Harm:

6. The premises will operate a "Challenge 25" policy whereby any person attempting to buy alcohol who appears to be under 25 will be asked for photographic ID to prove their age. The only forms of ID that will be accepted are passports, driving licences with a photograph or Portman Group, Citizen Card or Validate proof of age cards bearing the 'PASS' mark hologram. The list of approved forms of ID may be amended or revised with the prior written agreement of Sussex Police and the Licensing Authority without the need to amend the licence or conditions attaching to it.
7. Suitable and sufficient signage advertising the "Challenge 25" policy will be displayed in prominent locations of the premises.
8. All staff members engaged, or to be engaged, in selling alcohol on the premises shall receive the following training in age-restricted sales:
 - a. Induction training which must be completed, and fully documented, prior to the sale of alcohol by the staff member; and refresher training at intervals of no less than 8 weeks.
 - b. All age-restricted sales training undertaken by staff members shall be fully documented and recorded. All training records shall be made available to Sussex Police and Brighton & Hove Trading Standards Service upon request.



Brighton & Hove City Council

9. The premises shall at all times maintain and operate an age-restricted sales refusals book which shall be reviewed by the Designated Premises Supervisor at intervals of no less than 4 weeks and feedback given to staff as relevant. This refusals book shall be available upon request to police staff, Local Authority staff and Brighton & Hove Trading Standards.

Annex 3 – Conditions attached after a hearing by the licensing authority – N/A



Brighton & Hove City Council

Annex 4 - Plans

7 Lewes Road BN2 3HP FLOOR PLAN

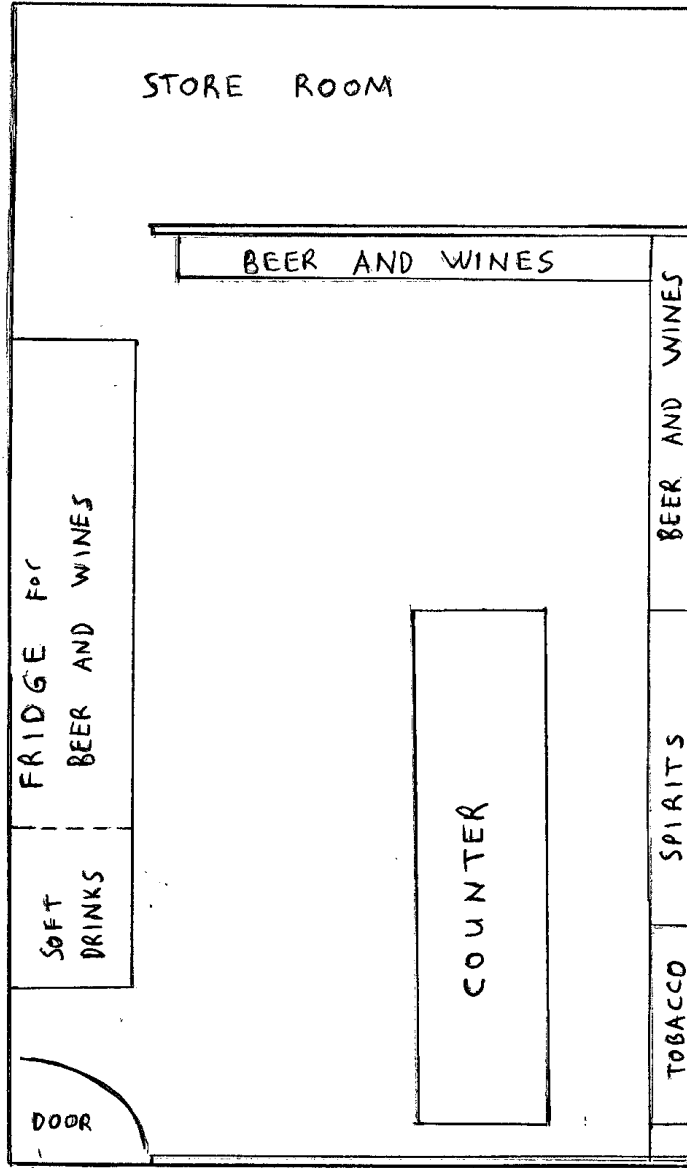

Appendix C

Sarah Cornell
Licensing Authority
Brighton & Hove City Council
Bartholomew House
Bartholomew Square
Brighton
BN11JP

Date: 22 June 2022
Our Ref: 2022/01370/LICREP/EH
Phone: 01273 292494

e-mail: donna.lynsdale@brighton-hove.gov.uk

Dear Sarah Cornell

Licensing Act 2003

Representation to the application for a Variation of a Premises Licence - 2022/01761/LAPREV

Wine Me Up, 7 Lewes Road, Brighton BN2 3HP

I write to make a representation on behalf of the Council's Licensing Team, in their capacity as a responsible authority, in relation to the above application to vary a Premises Licence submitted by Wine Me Up.

This representation is made as the Licensing Team have concerns that the application could have a negative impact on the licensing objectives of Prevention of Crime and Disorder and the Prevention of Public Nuisance and that this application falls within our Special Stress Area (SSA) and is contrary to our Statement of Licensing policy (SoLP).

As mentioned above, this premises sits within the Special Stress Area, which, as stated in our SoLP on pages 15-17, is deemed an area of special concern in terms of the levels of crime and disorder and nuisance experienced within it. 3.2.3 of our SoLP states that new and variation applications for premises within the SSA will not be subject to the presumption of refusal, but operators will be expected to pay special attention when drawing up their operating schedules and to make positive proposals to ensure that their operation will not add to the problems faced in these areas.

The Council's SoLP includes a Matrix approach for licensing decisions with provisions for a terminal hour for all classes of licensed premises in a particular area. The Matrix Model recognises the diverse operation and different risks presented by different classes of licensed premises. The SoLP provides a vision of what the Licensing Authority would like to see within its area and gives an indication of likelihood of

success or otherwise to investors and local businesses making applications. Each application is still considered on its individual merit and there is discretion to depart from the Matrix approach policy in exceptional circumstances.

The decision-making Matrix on page 18 of the Council's Statement of Licensing Policy suggests that any new premises or premises licence variations asking for these licensable activities and hours are a 'No' in the Special Stress Area.

On looking at the application form, particularly section 16 (licensing objectives), the applicant has not addressed the premise's location within the SSA. They also have not demonstrated exceptional circumstances to depart from our policy or how they will not add to the existing negative cumulative effect in an area already saturated with licensed premises and experiencing high levels of crime and disorder.

The Licensing Authority will always consider the circumstances of each case and whether there are exceptional circumstances to justify departing from its SPCI in the light of the individual circumstances of the case.

As well as being located in the Special Stress Area, the premises is situated in the electoral ward of St. Peter's and North Laine Ward. According to our Public Health Framework report for Assessing Alcohol Licensing also includes 'crime and disorder data', within this ward. St. Peter's and North Laine Ward is ranked (out of 21 wards) worst for 'police recorded alcohol related incidents and criminal damage', and second worst for 'all violence against the person' and 'all injury violence'. Which further highlights the impact that licensed premises in the area can have on crime and disorder and public nuisance.

On 20 June 2022 I carried out a full licensing inspection at the premise. Following this inspection, on 22 June 2022, I emailed the premises licence holder advising of the breaches of the current premises licence found at the time of this inspection. A copy of this email is attached as Appendix A.

The Licensing Team make this representation to uphold our Statement of Licensing Policy. Granting a licence with later terminal hours is likely to facilitate post-loading, late night binge drinking and street drinking in Lewes Road and surrounding areas. I do not believe that the applicant has demonstrated that there are exceptional circumstances to justify departing from the Policy. I therefore invite the Licensing Panel to refuse this application.

Yours sincerely

Redacted Text

Donna Lynsdale

Licensing Officer

Licensing Team

SC CON ENDS 22.06.22 VALID PCD, PPN, SSA (A)

Appendix A – Email to PLH and DPS outlining Breaches

From: Donna Lynsdale

Sent: 22 June 2022 08:27

To: Redacted Text

Cc: Brighton.Licensing@sussex.police.uk

Subject: Wine Me Up, 7 Lewes Road, Brighton BN2 3HP - 2022/01558/LICPRM/EH

Importance: High

Dear Redacted Text

Licensing Act 2003 – Breach of Conditions

Wine Me Up, 7 Lewes Road, Brighton BN2 3HP

Premises Licence Number: 1445/3/2022/00372/LAPRET

I am writing to you in your capacity as the Premises Licence Holder (PLH) and Designated Premises Supervisor (DPS) for the above premises.

On Monday 20 June 2022, I visited your premises and carried out a full licensing inspection. At the time of my visit, I spoke with Redacted Text.

Below are my findings and details of breaches of your premises licence conditions:

Annex 2 – Conditions consistent with the Operating Schedule

The Prevention of Crime and Disorder:

1. Digital CCTV and appropriate recording equipment to be installed, operated and maintained throughout the premises externally and internally to cover all public areas with sufficient numbers of cameras as agreed with Sussex Police. CCTV footage will be stored for a minimum of 28 days, and the management will give full and immediate cooperation and technical assistance to the Police in the event that CCTV footage is required for the prevention and detection of suspected or alleged crime. The CCTV images will record and display dates and times, and these times will be checked regularly to ensure their accuracy. The management of the premises will ensure that key staff are fully trained in the operation of the CCTV, and will be able to download certain footage onto a disk for the police without difficulty or delay.

At the time of my visit you advised that you did not have a screen to be able to view the CCTV. However, you could access via your phone. CCTV footage was only stored for 17 days and the time was incorrect. This is a breach of the above condition.

Public Safety:

2. The applicant will have two members of staff on the premises from 21:00hrs to 01:00hrs Friday and Saturday whilst alcohol is on sale.

You informed me that currently there was only yourself and Redacted Text working. One does the early shift and the other a late on alternate weeks. However, on Friday and Saturday nights you both work.

The Prevention of Public Nuisance:

3. Suitable signage will be displayed at the exit requesting patrons to respect neighbours and leave quietly.

No signage was displayed.

The Protection of Children from Harm:

7. Suitable and sufficient signage advertising the "Challenge 25" policy will be displayed in prominent locations of the premises.

At the time of my inspection you did have signage on display.

8. All staff members engaged, or to be engaged, in selling alcohol on the premises shall receive the following training in age-restricted sales:
 - a. Induction training which must be completed, and fully documented, prior to the sale of alcohol by the staff member; and refresher training at intervals of no less than 8 weeks.
 - b. All age-restricted sales training undertaken by staff members shall be fully documented and recorded. All training records shall be made available to Sussex Police and Brighton & Hove Trading Standards Service upon request.

You were not able to provide any training records. You informed me that both you and Kinan had personal licences and you did not have any other staff at present.

9. The premises shall at all times maintain and operate an age-restricted sales refusals book which shall be reviewed by the Designated Premises Supervisor at intervals of no less than 4 weeks and feedback given to staff as relevant. This refusals book shall be available upon request to police staff, Local Authority staff and Brighton & Hove Trading Standards.

Although your Refusal book was being used regularly, this had been reviewed. This is a breach of the above condition. As per the condition above, you must review and sign at intervals of no less than 4 weeks.

Also, at the time of our visit, you had a number of drug paraphernalia items on sale. Please be mindful, that if your premises is every taken to review, we would also raise that these items are being sold. Below is some guidance regarding selling these kind of items:

Supplying Paraphernalia

It is a criminal offence to supply, or offer to supply an object for providing or preparing a controlled drug. The maximum sentence is 6 months imprisonment and/or a fine up to level 5.

The offence will be committed if all of the following things happen:

- An object is supplied or offered to be supplied.
- The object could be used or changed to be used (either by itself or together with another object or objects) to provide a controlled drug.
- The person supplying or offering to supply the object believed that it would be used by any person to give the drug to themselves or another person.
- The provision of the drug would be illegal (certain people such as doctors and dentists are legally allowed to provide drugs).

Objects such as crack pipes, grinders, spoons, bongs and tourniquets could fall within this prohibition.

I remind you that non-compliance with conditions constitutes a breach of the Premises Licence issued under the above legislation. Please ensure that all conditions on the licence are adhered to. It is an offence under the Licensing Act 2003, S136(1) and (4) to carry on unauthorised licensable activities. The legislation states that:-

- (1) A Person commits an offence if –
 - (a) he carries on or attempts to carry on a licensable activity on or from any premises otherwise than under and in accordance with an authorisation, or
 - (b) he knowingly allows a licensable activity to be carried on.
- (4) A person guilty of an offence under this section is liable on summary conviction to imprisonment for a term not exceeding six months or to an unlimited fine, or to both.

Irrespective of the permission's and restrictions attached to any premises licence, all licensed premises are required to operate with regard to the 4 licensing objectives, which are;

- o The Prevention of Crime and Disorder
- o Public Safety
- o Prevention of Public Nuisance
- o Protection of Children from Harm

Please be aware that any enforcement action is taken in line with our Licensing Enforcement Policy. You are also reminded that at any stage, following the grant of a premises licence, a responsible authority, such as the Police, Environmental Health, or an interested party such as a resident living in the vicinity of the premises, may ask the Licensing Authority to review the licence because of a matter arising at the premises in connection with any of the four licensing objectives.

A copy of this email has also been sent to Police Licensing.

Please acknowledge receipt of this email and advise on actions you have taken.

Regards

Donna Lynsdale | Fair Trading Officer & Licensing Officer (Trading Standards & Licensing), Safer Communities
Brighton & Hove City Council, 2nd Floor, Barts House, Barts Square, BN1 1JP
T 01273 292494 | M 07717 303114 | donna.lynsdale@brighton-hove.gov.uk

Police Station

John Street

Brighton

BN2 0LA

Tel: 01273 404535 ext 550809

Email:

brighton.licensing@sussex.police.uk

17th June 2022

The Licensing Technical Support Officers
Environmental Health, Brighton & Hove City Council
Bartholomew House, Bartholomew Square
Brighton, East Sussex
BN1 1JP

SC CON ENDS 22.06.22 VALID PCD, SSA (B)

Dear Sarah Cornell,

RE: APPLICATION FOR A VARIATION OF PREMISES LICENCE FOR WINE ME UP, 7 LEWES ROAD, BRIGHTON, EAST SUSSEX, BN2 3HP UNDER THE LICENSING ACT 2003.

I write on behalf of the Chief Officer of Police for Sussex to raise a representation against the grant of the above application on the grounds that it will undermine the Licensing Objectives of the prevention of crime and disorder. We also make reference to the Brighton & Hove City Council (BHCC) Statement of Licensing Policy (revised January 2021) and the Revised Guidance issued under section 182 of the Licensing Act 2003 (April 2018).

This is a proposed variation licence application in an area of the City which is subject to a Special Policy adopted by Brighton & Hove City Council. The premises lies in the Special Stress Area (SSA) (as defined in the BHCC Statement of Licensing Policy) and seeks the following hours and licensable activities:

Supply of Alcohol (off sales)

Sunday to Thursday: 07:00 – 02:00

Friday to Saturday: 07:00 – 03:00

Opening hours

Sunday to Thursday: 07:00 – 02:00

Friday to Saturday: 07:00 – 03:00

Paragraph 3.2.2 of the Brighton and Hove City Council 2021 Statement of Licensing Policy states:

“This Special Stress Area (SSA) is of concern to the licensing authority because of the relatively high levels of crime and disorder and nuisance experienced within it.”

Lewes Road is a through road from the city centre to both the universities and out of the city.

It is a busy area which is highly residential but also has a variety of premises including Café/Bars, Off licences, pubs, restaurants and Late Night take-aways.

The licensing decision matrix on page 18 of the Council Statement of Licensing Policy (SoLP) suggests that new premises or premises licence variations asking for these licensable activities and hours are a ‘No’. While Paragraph 3.2.3 states that within the SSA *“applications will not be subject to the presumption of refusal”* it goes on to state that *“operators will be expected to pay special attention when drawing up their operating schedules and to make positive proposals to ensure that their operation will not add to the problems faced in these areas”*. The applicant has not referred to the Special Policy or the BHCC Statement of Licensing Policy (SoLP) in their application, despite consulting with Sussex Police and been given advice to read the SoLP. The applicant has not acknowledged any local concerns or offered particular reasoning as to why their application would be an exception to policy or why the SoLP matrix should be departed from considering the hours already granted on this premises licence.

Paragraph 14.40 of the Secretary of State’s Guidance to the Licensing Act 2003 (April 2018) provides:

‘In publishing a CIA a licensing authority is setting down a strong statement of intent about its approach to considering applications for the grant or variation of premises

licences or club premises certificates in the area described...Applications in areas covered by a CIA should therefore give consideration to potential cumulative impact issues when setting out the steps that will be taken to promote the licensing objectives.'

Lewes Road and surrounding areas in the last two years have suffered from high levels of crime and disorder. This is evidenced by crime and disorder statistics which show a total of 518 crimes in a quarter mile radius of this premises over the last year (18/06/2021 – 17/06/2022). 214 of the 518 crimes were violence against the person and 72 were theft.

This is supported by the Brighton & Hove Public Health Framework for Assessing Alcohol Licensing (accessed at <https://public.tableau.com/app/profile/brightonhovepublichealthintelligence/viz/PublicHealthFrameworkforAssessingAlcoholLicensing/NavigationPage>) as this premises lies within St. Peter's and North Laine Ward which is ranked number 1 for Police recorded alcohol related incidents and criminal damage. This ward is also ranked number 2 for All violence against the person and All injury violence, demonstrating the higher risk to the Licensing Objective of the Prevention of Crime and Disorder in this area.

The applicant has offered some information under Section 16 of their application with minimal workable conditions and Sussex Police do not believe these go far enough to help mitigate any potential risk in this area of the City. The conditions offered fall far short of the current city wide expected standard and while there is some mention of crime prevention measures such as CCTV and no alcohol located near the entrance, these have not been elaborated on. Sussex Police additionally contend that the carrying on of additional licensable activity and the extended hours applied for at these premises will add to the existing negative cumulative effect in an area already saturated with licensed premises and experiencing high levels of crime and disorder.

Therefore, Sussex Police invite the Licensing Authority to seriously consider refusing this application.

Yours sincerely,

Redacted Text

Insp Michelle Palmer-Harris

Ops Planning and Events (inc. Licensing) Inspector

Brighton & Hove Division

Sussex Police

Please address all future correspondence to Brighton & Hove Licensing Unit, Police Station, John Street, Brighton, BN2 0LA.

Appendix D



